

get connected with

# *butt-weld* fittings



**Bradford** Company, Inc.

800.789.1718 • [www.bradfordfittings.com](http://www.bradfordfittings.com)

# For the right butt-weld

clamps

end caps

hangers

ferrules

elbows

tees

laterals

reducers

valves

gaskets

Your applications demand quality and reliability at a competitive price. And you need affordable parts and quick delivery to hold down inventory costs.

That's why businesses from dairy, food and beverage to pharmaceutical and cosmetics have trusted **Bradford** butt-weld fittings for over 14 years.

Butt-weld fittings are used to assemble permanent systems that do not require breakdown for service or cleaning. **Bradford** butt-weld fittings are manufactured to very high tolerances, making these superior-quality fittings easier to weld together properly, regardless of your layout design.

Bradford provides butt-weld fittings in a wide variety of sizes and configurations; this combination of versatility and quality is unsurpassed in our industry.

**Bradford** offers high-tolerance butt-weld fittings in-stock from our many warehouses around the world – so we can ship the parts you (or your customers) need within a day of your call.

For the right fitting at the right price, **connect with Bradford.**



Bradford Co., Inc. stands behind its products. If, within one year of shipment, any part fails to perform to your satisfaction because of defects in material or workmanship, return the part and Bradford will, at our option, repair or replace it.

Note: Dimensions are approximate. Engineering dimensions available on request. Specifications are subject to change without notice. Some items may not be in stock. Please allow at least 4 weeks for special orders. Inquiries welcome on items available in future or not pictured.

# fitting at the right price...

*we're your in-stock connection.*

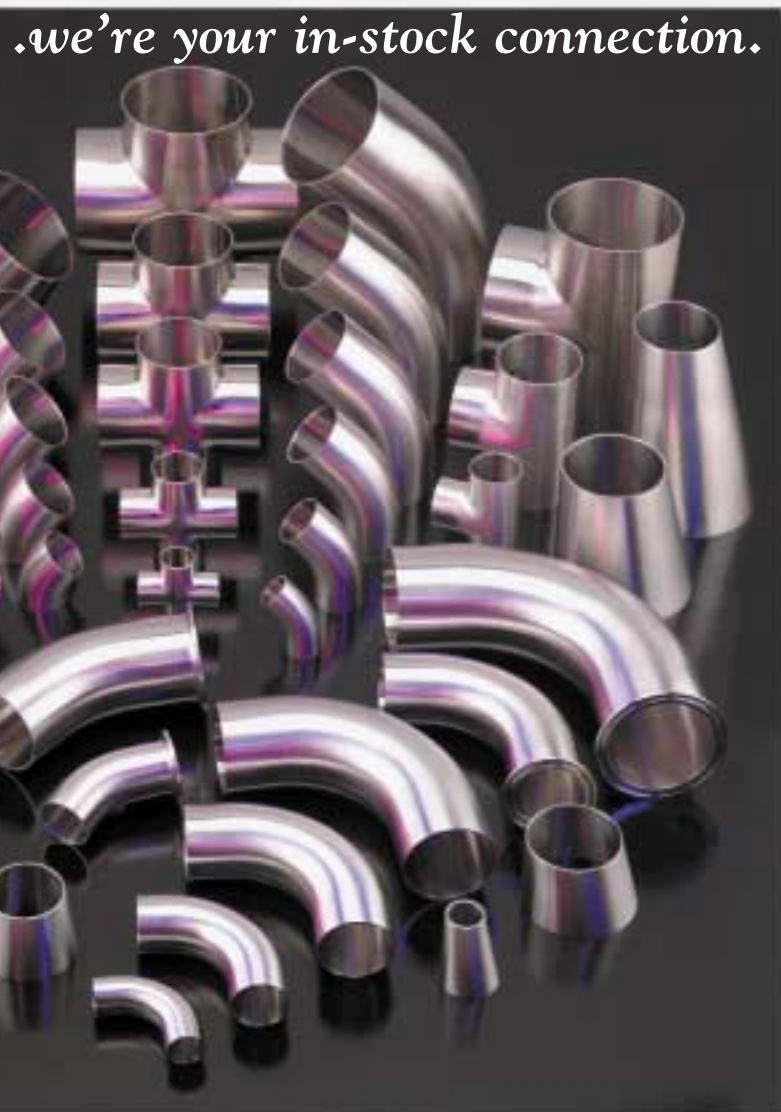

## Bradford quality: maintaining the standard

The  Sanitary Standard was created by the dairy industry as a voluntary benchmark for product performance and sanitary safety. The standard, collaboratively developed by a group of processors, suppliers, regulatory officials and sanitation specialists, is generally accepted by federal, state and local regulatory authorities.

Our products have earned the  symbol, which requires an annual assessment to make certain each product conforms in all respects to the published standard.

Bradford Co., Inc. is proud to be a participant in the  program.

### contents

elbows	4-5
tees	6
tees & crosses	7
reducers	8-9

Part of the



### product specifications

- size range:** • 1" – 12" OD
- materials:** • 304  
• 316L
- finish:** • No. 7 – polished ID and OD  
• No. 5 – polished OD only  
• No. 3 – polished ID only  
• No. 1 – unpolished – tumbled

*Other finishes also available. Some items may not be in stock. Call for price and availability. If your part is not listed, call us; we may still be able to get it for you.*

### ordering instructions

- specify:**
- quantity
  - product description and Bradford part number
  - size
  - material type
  - polish requirements
  - ship to address

Bradford butt-weld fittings

# elbows

4

## 90°

### 90° elbow with tangent

**B2S7**

od tube size	A	nom wall
1"	2.062"	.065"
1½"	2.937"	.065"
2"	4.062"	.065"
2½"	5.187"	.065"
3"	6.312"	.065"
4"	8.312"	.083"

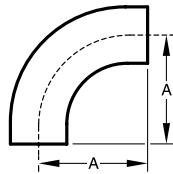

### 90° elbow less tangent

**B2WCL7**

od tube size	A	nom wall
1"	1.50"	.065"
1½"	2.25"	.065"
2"	3.00"	.065"
2½"	3.75"	.065"
3"	4.50"	.065"
4"	6.00"	.083"
6"	9.00"	.109"
8"	12.00"	.120"
10"	15.00"	.109"
12"	18.00"	.120"

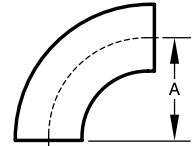

6" – 12" see Larger Materials brochure.

### 90° elbow threaded bevel by clamp

**B2T**

od tube size	A	B	nom wall
1"	2.062"	2.780"	.065"
1½"	2.937"	3.656"	.065"
2"	4.062"	4.812"	.065"
2½"	5.187"	6.062"	.065"
3"	6.312"	7.218"	.065"
4"	8.312"	9.343"	.083"

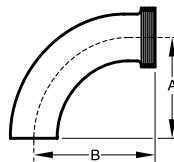

Call for availability.

### 90° elbow clamp by weld

**B2CM**

od tube size	A	B	nom wall
1"	2.062"	2.562"	.065"
1½"	2.937"	3.438"	.065"
2"	4.187"	4.688"	.065"
2½"	5.187"	5.688"	.065"
3"	6.312"	6.812"	.065"
4"	8.312"	8.937"	.083"

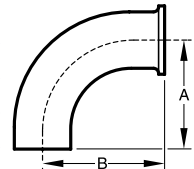

### 90° elbow plain bevel w/hex nut by weld

**B2FP**

od tube size	A	B	nom wall
1"	2.062"	2.780"	.065"
1½"	2.739"	3.656"	.065"
2"	4.062"	4.812"	.065"
2½"	5.187"	6.062"	.065"
3"	6.312"	7.218"	.065"
4"	8.312"	9.343"	.083"

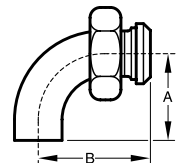

Call for availability.



International Association of  
Food Industry Suppliers

## 45°

45° elbow with tangent			B2KS7
od tube size	A	nom wall	
1"	1.188"	.065"	
1½"	1.625"	.065"	
2"	2.312"	.065"	
2½"	3.000"	.065"	
3"	3.688"	.065"	
4"	4.812"	.083"	

45° elbow less tangent				B2WK7
od tube size	A	B	nom wall	
1"	.625"	1.50"	.065"	
1½"	.937"	2.25"	.065"	
2"	1.250"	3.00"	.065"	
2½"	1.562"	3.75"	.065"	
3"	1.875"	4.50"	.065"	
4"	2.500"	6.00"	.083"	
6"	3.750"	12.00"	.109"	
8"	5.000"	16.00"	.120"	
10"	6.250"	20.00"	.109"	
12"	7.500"	24.00"	.120"	

6" - 12" see Larger Materials brochure.

45° elbow threaded bevel by weld				B2KT
od tube size	A	B	nom wall	
1"	1.906"	1.188"	.065"	
1½"	2.343"	1.625"	.065"	
2"	3.062"	2.312"	.065"	
2½"	3.875"	3.000"	.065"	
3"	4.594"	3.688"	.065"	
4"	5.843"	4.812"	.083"	

Call for availability.

45° elbow clamp by weld				B2KM
od tube size	A	B	nom wall	
1"	1.188"	1.688"	.065"	
1½"	1.625"	2.125"	.065"	
2"	2.312"	2.812"	.065"	
2½"	3.000"	3.500"	.065"	
3"	3.688"	4.188"	.065"	
4"	4.812"	5.437"	.083"	

45° elbow plain bevel w/hex nut by weld				B2KP
od tube size	A	B	nom wall	
1"	1.906"	1.188"	.065"	
1½"	2.343"	1.625"	.065"	
2"	3.062"	2.312"	.065"	
2½"	3.875"	3.000"	.065"	
3"	4.594"	3.688"	.065"	
4"	5.843"	4.812"	.083"	

Call for availability.

## 304 · 316L

tee				B7WW7
od tube size	A	nom wall		
1"	1.125"	.065"		
1½"	1.656"	.065"		
2"	2.062"	.065"		
2½"	2.344"	.065"		
3"	2.594"	.065"		
4"	3.438"	.083"		

tee long					B7W7
od tube size	A	B	nom wall		
1"	1.875"	3.75"	.065"		
1½"	2.250"	4.50"	.065"		
2"	3.000"	6.00"	.065"		
2½"	3.000"	6.00"	.065"		
3"	3.250"	6.50"	.065"		
4"	3.875"	7.75"	.083"		
6"	5.625"	11.25"	.109"		
8"	7.000"	14.00"	.120"		
10"	8.500"	17.00"	.109"		
12"	10.000"	20.00"	.120"		

6" - 12" see Larger Materials brochure.

tee				B7WWM
od tube size	A	B	nom wall	
1"	1.125"	1.625"	.065"	
1½"	1.656"	2.156"	.065"	
2"	2.062"	2.562"	.065"	
2½"	2.344"	2.844"	.065"	
3"	2.594"	3.094"	.065"	
4"	3.438"	4.063"	.083"	

tee				B7WMM
od tube size	A	B	nom wall	
1"	1.625"	1.125"	.065"	
1½"	2.156"	1.656"	.065"	
2"	2.562"	2.062"	.065"	
2½"	2.844"	2.344"	.065"	
3"	3.094"	2.594"	.065"	
4"	3.438"	4.062"	.083"	

tee				B7WMW
od tube size	A	B	nom wall	
1"	1.625"	1.125"	.065"	
1½"	2.156"	1.656"	.065"	
2"	2.562"	2.062"	.065"	
2½"	2.844"	2.344"	.065"	
3"	3.094"	2.594"	.065"	
4"	4.063"	3.438"	.083"	

tee					B7MMW
od tube size	A	AA	B	nom wall	
1"	1.625"	3.250"	1.125"	.065"	
1½"	2.156"	4.312"	1.656"	.065"	
2"	2.562"	5.125"	2.062"	.065"	
2½"	2.844"	5.688"	2.344"	.065"	
3"	3.094"	6.188"	2.594"	.065"	
4"	4.062"	8.125"	3.438"	.083"	

Call for availability.



International Association of Food Industry Suppliers

## 304 · 316L

tee				B7WTT
od tube size	A	B	nom wall	
1"	1.125"	1.843"	.065"	
1½"	1.656"	2.374"	.065"	
2"	2.062"	2.812"	.065"	
2½"	2.344"	3.219"	.065"	
3"	2.594"	3.500"	.065"	
4"	3.438"	4.469"	.083"	

Call for availability.

tee					B7TTW
od tube size	A	B	C	nom wall	
1"	1.125"	1.843"	3.686"	.065"	
1½"	1.656"	2.375"	4.748"	.065"	
2"	2.062"	2.812"	5.624"	.065"	
2½"	2.344"	3.219"	6.438"	.065"	
3"	2.594"	3.500"	7.000"	.065"	
4"	3.438"	4.469"	8.938"	.083"	

Call for availability.

tee				B7WTW
od tube size	A	B	nom wall	
1"	1.843"	1.125"	.065"	
1½"	2.375"	1.656"	.065"	
2"	2.813"	2.062"	.065"	
2½"	3.219"	2.343"	.065"	
3"	3.500"	2.593"	.065"	
4"	4.469"	3.438"	.083"	

Call for availability.

tee				B7WWT
od tube size	A	B	nom wall	
1"	1.125"	1.843"	.065"	
1½"	1.656"	2.375"	.065"	
2"	2.062"	2.812"	.065"	
2½"	2.343"	3.219"	.065"	
3"	2.593"	3.500"	.065"	
4"	3.438"	4.469"	.083"	

Call for availability.

reducing tee						B7RWWW7
od tube size	A	B	C	D	nom wall	
1½"x1"	1.656"	1.375"	1.50"	1.00"	.065"	
2"x1"	2.062"	1.625"	2.00"	1.00"	.065"	
2"x1½"	2.062"	1.906"	2.00"	1.50"	.065"	
2½"x1"	2.344"	1.875"	2.50"	1.00"	.065"	
2½"x1½"	2.344"	2.156"	2.50"	1.50"	.065"	
2½"x2"	2.344"	2.312"	2.50"	2.00"	.065"	
3"x1½"	2.594"	2.406"	3.00"	1.50"	.065"	
3"x2"	2.594"	2.561"	3.00"	2.00"	.065"	
3"x2½"	2.594"	2.594"	3.00"	2.50"	.065"	
4"x1½"	3.438"	2.906"	4.00"	1.50"	.083"	
4"x2"	3.438"	3.062"	4.00"	2.00"	.083"	
4"x2½"	3.438"	3.094"	4.00"	2.50"	.083"	
4"x3"	3.438"	3.156"	4.00"	3.00"	.083"	

cross				B9WWW
od tube size	A	B	nom wall	
1"	1.125"	2.250"	.065"	
1½"	1.656"	3.312"	.065"	
2"	2.062"	4.125"	.065"	
2½"	2.343"	4.687"	.065"	
3"	2.593"	5.187"	.065"	
4"	3.437"	6.875"	.083"	

Call for availability.

## concentric

concentric reducer					B31W7
od tube size	A	B	C	nom wall	
1½"x1"	2.0"	1.50"	1.00"	.065"	
2"x1"	4.0"	2.00"	1.00"	.065"	
2"x1½"	2.0"	2.00"	1.50"	.065"	
2½"x1½"	4.0"	2.50"	1.50"	.065"	
2½"x2"	2.0"	2.50"	2.00"	.065"	
3"x1½"	6.0"	3.00"	1.50"	.065"	
3"x2"	4.0"	3.00"	2.00"	.065"	
3"x2½"	2.0"	3.00"	2.50"	.065"	
4"x1½"	10.0"	4.00"	1.50"	.083"	
4"x2"	8.0"	4.00"	2.00"	.083"	
4"x2½"	6.0"	4.00"	2.50"	.083"	
4"x3"	4.0"	4.00"	3.00"	.083"	
6"x3"	5.5"	6.00"	3.00"	.109"	
6"x4"	5.5"	6.00"	4.00"	.109"	
8"x4"	6.0"	8.00"	4.00"	.120"	
8"x6"	6.0"	8.00"	6.00"	.120"	
10"x6"	7.0"	10.00"	6.00"	.109"	
10"x8"	7.0"	10.00"	8.00"	.109"	
12"x8"	8.0"	12.00"	8.00"	.120"	
12"x10"	8.0"	12.00"	10.00"	.120"	

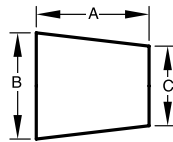

6" - 12" see Larger Materials brochure.

concentric reducer clamp by weld					B31M
od tube size	A	B	C	nom wall	
1½"x1"	2.500"	1.50"	1.00"	.065"	
2"x1"	4.500"	2.00"	1.00"	.065"	
2"x1½"	2.500"	2.00"	1.50"	.065"	
2½"x1½"	4.500"	2.50"	1.50"	.065"	
2½"x2"	2.500"	2.50"	2.00"	.065"	
3"x1½"	6.500"	3.00"	1.50"	.065"	
3"x2"	4.500"	3.00"	2.00"	.065"	
3"x2½"	2.500"	3.00"	2.50"	.065"	
4"x1½"	10.625"	4.00"	1.50"	.083"	
4"x2"	8.625"	4.00"	2.00"	.083"	
4"x2½"	6.625"	4.00"	2.50"	.083"	
4"x3"	4.625"	4.00"	3.00"	.083"	
6"x3"	5.500"	6.00"	3.00"	.109"	
6"x4"	5.500"	6.00"	4.00"	.109"	
8"x4"	6.000"	8.00"	4.00"	.120"	
8"x6"	6.000"	8.00"	6.00"	.120"	
10"x6"	7.000"	10.00"	6.00"	.109"	
10"x8"	7.000"	10.00"	8.00"	.109"	
12"x8"	8.000"	12.00"	8.00"	.120"	
12"x10"	8.000"	12.00"	10.00"	.120"	

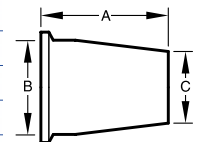

Call for availability.

6" - 12" see Larger Materials brochure.

concentric reducer plain bevel by weld					B31P
od tube size	A	B	C	nom wall	
1½"x1"	2.718"	1.50"	1.00"	.065"	
2"x1"	4.750"	2.00"	1.00"	.065"	
2"x1½"	2.750"	2.00"	1.50"	.065"	
2½"x1½"	4.875"	2.50"	1.50"	.065"	
2½"x2"	2.875"	2.50"	2.00"	.065"	
3"x1½"	6.906"	3.00"	1.50"	.065"	
3"x2"	4.906"	3.00"	2.00"	.065"	
3"x2½"	2.906"	3.00"	2.50"	.065"	
4"x1½"	11.030"	4.00"	1.50"	.083"	
4"x2"	9.031"	4.00"	2.00"	.083"	
4"x2½"	7.031"	4.00"	2.50"	.083"	
4"x3"	5.031"	4.00"	3.00"	.083"	

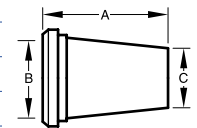

Call for availability.



International Association of Food Industry Suppliers

## eccentric

eccentric reducer					B32W7
od tube size	A	B	C	nom wall	
1½"x1"	2.000"	1.50"	1.00"	.065"	
2"x1"	4.000"	2.00"	1.00"	.065"	
2"x1½"	2.000"	2.00"	1.50"	.065"	
2½"x1½"	4.000"	2.50"	1.50"	.065"	
2½"x2"	2.000"	2.50"	2.00"	.065"	
3"x1½"	6.000"	3.00"	1.50"	.065"	
3"x2"	4.000"	3.00"	2.00"	.065"	
3"x2½"	2.000"	3.00"	2.50"	.065"	
4"x1½"	10.000"	4.00"	1.50"	.083"	
4"x2"	8.000"	4.00"	2.00"	.083"	
4"x2½"	6.000"	4.00"	2.50"	.083"	
4"x3"	4.000"	4.00"	3.00"	.083"	
6"x3"	6.375"	6.00"	3.00"	.109"	
6"x4"	6.375"	6.00"	4.00"	.109"	
8"x4"	6.875"	8.00"	4.00"	.120"	
8"x6"	6.875"	8.00"	6.00"	.120"	
10"x6"	7.875"	10.00"	6.00"	.109"	
10"x8"	7.875"	10.00"	8.00"	.109"	
12"x8"	8.875"	12.00"	8.00"	.120"	
12"x10"	8.875"	12.00"	10.00"	.120"	

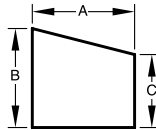

6" - 12" see Larger Materials brochure.

eccentric reducer clamp by weld					B32M
od tube size	A	B	C	nom wall	
1½"x1"	2.500"	1.50"	1.00"	.065"	
2"x1"	4.500"	2.00"	1.00"	.065"	
2"x1½"	2.500"	2.00"	1.50"	.065"	
2½"x1½"	4.500"	2.50"	1.50"	.065"	
2½"x2"	2.500"	2.50"	2.00"	.065"	
3"x1½"	6.500"	3.00"	1.50"	.065"	
3"x2"	4.500"	3.00"	2.00"	.065"	
3"x2½"	2.500"	3.00"	2.50"	.065"	
4"x1½"	10.625"	4.00"	1.50"	.083"	
4"x2"	8.625"	4.00"	2.00"	.083"	
4"x2½"	6.625"	4.00"	2.50"	.083"	
4"x3"	4.625"	4.00"	3.00"	.083"	
6"x3"	6.375"	6.00"	3.00"	.109"	
6"x4"	6.375"	6.00"	4.00"	.109"	
8"x4"	6.875"	8.00"	4.00"	.120"	
8"x6"	6.875"	8.00"	6.00"	.120"	
10"x6"	7.875"	10.00"	6.00"	.109"	
10"x8"	7.875"	10.00"	8.00"	.109"	
12"x8"	8.875"	12.00"	8.00"	.120"	
12"x10"	8.875"	12.00"	10.00"	.120"	

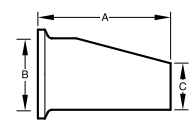

Call for availability.

6" - 12" see Larger Materials brochure.

eccentric reducer plain bevel by weld					B32P
od tube size	A	B	C	nom wall	
1½"x1"	2.718"	1.50"	1.00"	.065"	
2"x1"	4.750"	2.00"	1.00"	.065"	
2"x1½"	2.750"	2.00"	1.50"	.065"	
2½"x1½"	4.875"	2.50"	1.50"	.065"	
2½"x2"	2.875"	2.50"	2.00"	.065"	
3"x1½"	6.906"	3.00"	1.50"	.065"	
3"x2"	4.906"	3.00"	2.00"	.065"	
3"x2½"	2.906"	3.00"	2.50"	.083"	
4"x1½"	11.031"	4.00"	1.50"	.083"	
4"x2"	9.031"	4.00"	2.00"	.083"	
4"x2½"	7.031"	4.00"	2.50"	.083"	
4"x3"	5.031"	4.00"	3.00"	.083"	

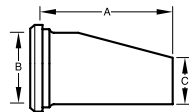

Call for availability.

get connected with

**Bradford** Company, Inc.



clamps

end caps

hangers

ferrules

elbows

tees

laterals

reducers

valves

gaskets



**Bradford Company, Inc.**

PO Box 33 • Elm Grove, WI 53122-0033

262.790.0101 • 800.789.1718

fax 262.790.1046

[www.bradfordfittings.com](http://www.bradfordfittings.com)

