

get connected with

I-line fittings



Bradford Company, Inc.

800.789.1718 • www.bradfordfittings.com

fittings

Why an I-line fitting?

clamps

end caps

hangers

ferrules

elbows

tees

laterals

reducers

valves

gaskets

Keeping maintenance and labor costs under control can be tough. And if your system uses regular-style flange-end stub joints, you could be having an even tougher time. That's because flange-end stub joints are cumbersome, hard to manage, and a pain to keep clean. By switching to **Bradford** I-line fittings, you can substantially reduce your labor costs.

I-line fittings use an easy clamp assembly (eyebolt and wing nut fastening) versus the 4, 6, or 8 nuts, bolts and washers required for flange-end stub joints. I-line fittings are lighter, easier to handle, and your system's lines will assemble and disassemble much more easily.

The real value to **Bradford** I-line fittings comes in the long haul. Easy disconnect means faster cleaning or repair. I-line fittings self align to save time; joints are crevice-free, allowing for quicker cleaning with error-free connections.

Bradford stocks wing nut and bolted clamps, male and female ferrules, and caps – all in 304 and 316 materials. Any I-line configuration can be made in 1" – 8" sizes from our stock of elbows, tees, and reducers. It's all waiting for you, in-stock from our many warehouses around the world – so we can ship the parts you (or your customers) need within a day of your call.

If your application demands quality at a competitive price, and you need better control over your maintenance costs, **connect with Bradford.**

Bradford Co., Inc. stands behind its products. If, within one year of shipment, any part fails to perform to your satisfaction because of defects in material or workmanship, return the part and Bradford will, at our option, repair or replace it.

Note: Dimensions are approximate. Engineering dimensions available on request. Specifications are subject to change without notice. Some items may not be in stock. Please allow at least 4 weeks for special orders. Inquiries welcome on items available in future or not pictured.



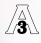

Bradford quality: maintaining the standard

The  Sanitary Standard was created by the dairy industry as a voluntary benchmark for product performance and sanitary safety. The standard, collaboratively developed by a group of processors, suppliers, regulatory officials and sanitation specialists, is generally accepted by federal, state and local regulatory authorities.

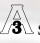
Our products have earned the  symbol, which requires an annual assessment to make certain each product conforms in all respects to the published standard.

Bradford Co., Inc. is proud to be a participant in the  program.

contents

clamps & end caps	4
ferrules	5
adapters-male	6
adapters-female	7
elbows	8
tees & crosses	9
reducers	10
reducers & gaskets	11

Part of the



International Association of
Food Industry Suppliers

product specifications

- size range:**
- ferrules: 1" – 8" OD
 - clamps: 1" – 8" OD
 - end caps 1" – 4"
- materials:**
- 304
 - 316
- finish:**
- No. 7 – ID and OD
 - Other finishes also available.

Some items may not be in stock. Call for price and availability. If your part is not listed, call us; we may still be able to get it for you.

ordering instructions

- specify:**
- quantity
 - product description
and Bradford part number
 - size
 - material type
 - polish requirements
 - ship to address

clamps & end caps

4

heavy duty • male • female

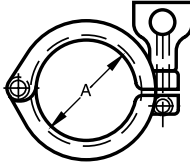
clamp heavy duty				13IL
od tube size	A	70° F	250° F service	
1"-1½"	2.122"	500 psi	250 psi	
2"	2.654"	450 psi	250 psi	
2½"	3.185"	450 psi	200 psi	
3"	3.717"	350 psi	150 psi	
4"	4.820"	200 psi	125 psi	
6"	7.689"	150 psi	100 psi	

6" see Larger Materials brochure.

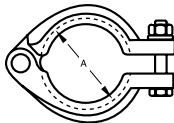
bolted clamp				13ILB
od tube size	A	70° F	250° F service	
1"-1½"	2.122"	1220 psi	1100 psi	
2"	2.654"	900 psi	830 psi	
2½"	3.185"	720 psi	660 psi	
3"	3.717"	600 psi	550 psi	
4"	4.820"	570 psi	525 psi	
6"	7.689"	300 psi	200 psi	
8"	9.689"	250 psi	150 psi	

6" - 8" see Larger Materials brochure.

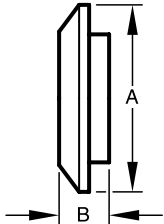
solid end cap male			16AI-14I
od tube size	A	B	
1"	2.000"	.500"	
1½"	2.000"	.500"	
2"	2.625"	.562"	
2½"	3.312"	.750"	
3"	3.875"	.700"	
4"	4.875"	.750"	

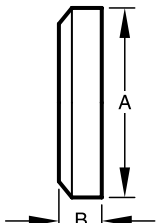
solid end cap female			16AI-15I
od tube size	A	B	
1"	2.000"	.500"	
1½"	2.000"	.500"	
2"	2.625"	.562"	
2½"	3.312"	.750"	
3"	3.875"	.700"	
4"	4.875"	.750"	



International Association of Food Industry Suppliers

long • short • male • female

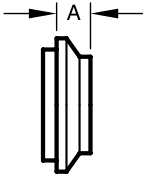
short male ferrule		14WI
od tube size	A	
1"	.600"	
1½"	.765"	
2"	.790"	
2½"	.848"	
3"	.906"	
4"	1.031"	
6"	.940"	
8"	.940"	

6" – 8" see Larger Materials brochure.

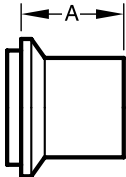
long male ferrule		14WLI
od tube size	A	
1"	1.562"	
1½"	1.843"	
2"	2.062"	
2½"	2.188"	
3"	2.375"	
4"	2.688"	

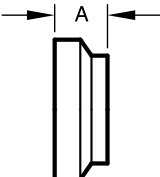
short female ferrule		15WI
od tube size	A	
1"	.785"	
1½"	.950"	
2"	1.040"	
2½"	1.160"	
3"	1.220"	
4"	1.350"	
6"	1.125"	
8"	1.125"	

6" – 8" see Larger Materials brochure.

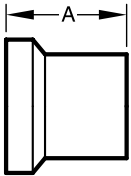
long female ferrule		15WLI
od tube size	A	
1"	1.750"	
1½"	2.031"	
2"	2.312"	
2½"	2.500"	
3"	2.688"	
4"	3.000"	

male • female

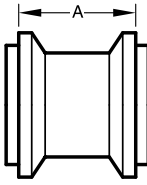
adapter male by male		17-14I-14I
od tube size	A	
1"	1.200"	
1½"	1.530"	
2"	1.580"	
2½"	1.696"	
3"	1.812"	
4"	2.062"	

Call for availability.

adapter male by female	
od tube size	A
1"	1.385"
1½"	1.715"
2"	1.830"
2½"	2.008"
3"	2.126"
4"	2.381"

Call for availability.

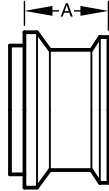
adapter male by clamp		17-14I-14MP
od tube size	A	
1"	1.093"	
1½"	1.250"	
2"	1.250"	
2½"	1.312"	
3"	1.406"	
4"	1.656"	

Call for availability.

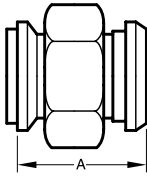
adapter male by plain bevel (with hex nut)		17-14I-14
od tube size	A	
1"	1.969"	
1½"	2.200"	
2"	2.250"	
2½"	2.562"	
3"	2.688"	
4"	2.812"	

Call for availability.

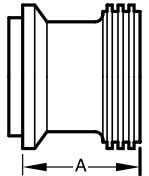
adapter male by threaded bevel		17-14I-15
od tube size	A	
1"	1.318"	
1½"	1.468"	
2"	1.500"	
2½"	1.688"	
3"	1.812"	
4"	2.062"	

Call for availability.



International Association of Food Industry Suppliers

male • female

17-14I-15I

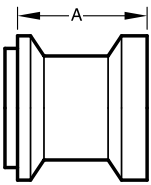

adapter female by female

od tube size	A
1"	1.562"
1½"	1.875"
2"	2.062"
2½"	2.312"
3"	2.437"
4"	2.688"

17-15I-15I

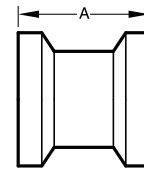

Call for availability.

adapter female by clamp

od tube size	A
1"	1.281"
1½"	1.437"
2"	1.000"
2½"	1.625"
3"	1.718"
4"	1.968"

17-15I-14MP

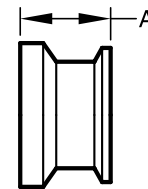

Call for availability.

adapter female by threaded bevel

od tube size	A
1"	1.500"
1½"	1.650"
2"	1.750"
2½"	2.000"
3"	2.125"
4"	2.375"

17-15I-15

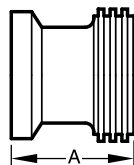

Call for availability.

adapter female by plain bevel (with hex nut)

od tube size	A
1"	2.156"
1½"	2.437"
2"	2.500"
2½"	2.875"
3"	3.000"
4"	3.093"

17-15I-14I

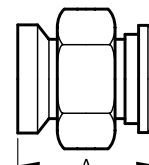

Call for availability.

elbows

8

90° · 45°

90° elbow male by female

B2FI

od tube size	A	B
1"	2.281"	2.093"
1½"	3.188"	3.000"
2"	4.031"	3.781"
2½"	4.906"	4.593"
3"	5.718"	5.406"
4"	7.344"	7.031"
6"	10.125"	9.940"
8"	13.125"	12.940"

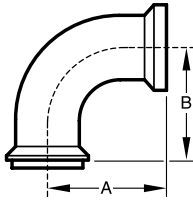

Call for availability.
6" - 8" see Larger Materials Brochure.

45° elbow female by male

B2PI

od tube size	A	B
1"	1.406"	1.218"
1½"	1.888"	1.688"
2"	2.281"	2.031"
2½"	2.718"	2.406"
3"	3.094"	2.781"
4"	3.844"	3.531"
6"	4.875"	4.690"
8"	6.125"	5.940"

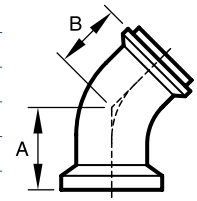

Call for availability.
6" - 8" see Larger Materials Brochure.

90° elbow female by female

B2CI

od tube size	A
1"	2.281"
1½"	3.188"
2"	4.031"
2½"	4.906"
3"	5.718"
4"	7.344"
6"	10.125"
8"	13.125"

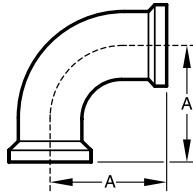

Call for availability.
6" - 8" see Larger Materials Brochure.

45° elbow female by female

B2KI

od tube size	A
1"	1.406"
1½"	1.888"
2"	2.281"
2½"	2.718"
3"	3.093"
4"	3.844"
6"	4.875"
8"	6.125"

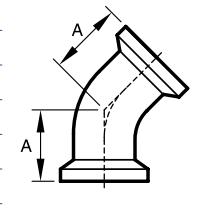

Call for availability.
6" - 8" see Larger Materials Brochure.

90° elbow male by male

B2EI

od tube size	A
1"	2.093"
1½"	3.000"
2"	3.781"
2½"	4.593"
3"	5.406"
4"	7.031"
6"	9.940"
8"	12.940"

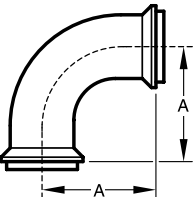

Call for availability.
6" - 8" see Larger Materials Brochure.

45° elbow male by male

B2HI

od tube size	A
1"	1.218"
1½"	1.688"
2"	2.031"
2½"	2.406"
3"	2.781"
4"	3.531"
6"	4.690"
8"	5.940"

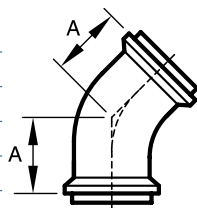

Call for availability.
6" - 8" see Larger Materials Brochure.



International Association of
Food Industry Suppliers

male • female

tee			B7AI
od tube size	A	B	
1"	1.688"	1.875"	
1½"	2.406"	2.594"	
2"	2.812"	3.062"	
2½"	3.156"	3.468"	
3"	3.500"	3.812"	
4"	4.468"	4.750"	
6"	6.565"	13.500"	
8"	7.940"	16.250"	

Call for availability.
6" – 8" see Larger Materials Brochure.

tee		B7I
od tube size	A	
1"	1.875"	
1½"	2.594"	
2"	3.062"	
2½"	3.468"	
3"	3.812"	
4"	4.750"	
6"	6.750"	
8"	8.125"	

Call for availability.
6" – 8" see Larger Materials Brochure.

tee			B7BI
od tube size	A	B	
1"	1.875"	1.688"	
1½"	2.594"	2.406"	
2"	3.062"	2.812"	
2½"	3.468"	3.156"	
3"	3.812"	3.500"	
4"	4.750"	4.468"	
6"	6.750"	13.315"	
8"	8.125"	16.065"	

Call for availability.
6" – 8" see Larger Materials Brochure.

tee		B7HI
od tube size	A	
1"	1.688"	
1½"	2.406"	
2"	2.812"	
2½"	3.156"	
3"	3.500"	
4"	4.468"	
6"	6.565"	
8"	7.940"	

Call for availability.
6" – 8" see Larger Materials Brochure.

cross		B9I
od tube size	A	
1"	2.660"	
1½"	3.200"	
2"	4.040"	
2½"	4.160"	
3"	4.470"	
4"	5.225"	

Call for availability.

concentric

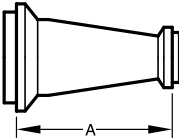
concentric reducer male by male		B31I-14I
od tube size	A	
1½" x 1"	3.365"	
2" x 1"	5.390"	
2" x 1½"	3.555"	
2½" x 1½"	5.613"	
2½" x 2"	3.638"	
3" x 1½"	7.665"	
3" x 2"	5.690"	
3" x 2½"	3.748"	
4" x 1½"	11.803"	
4" x 2"	9.828"	
4" x 2½"	7.886"	
4" x 3"	5.938"	

Call for availability.
6" - 8" see Larger Materials Brochure.

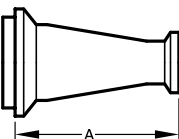
concentric reducer male by female		B31I-14I-15I
od tube size	A	
1½" x 1"	3.550"	
2" x 1"	5.575"	
2" x 1½"	3.740"	
2½" x 1½"	5.798"	
2½" x 2"	3.888"	
3" x 1½"	7.858"	
3" x 2"	5.948"	
3" x 2½"	6.068"	
4" x 1½"	11.988"	
4" x 2"	10.078"	
4" x 2½"	8.198"	
4" x 3"	6.258"	

Call for availability.
6" - 8" see Larger Materials Brochure.

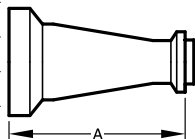
concentric reducer female by male		B31I-15I-14I
od tube size	A	
1½" x 1"	3.550"	
2" x 1"	5.640"	
2" x 1½"	3.805"	
2½" x 1½"	5.925"	
2½" x 2"	3.950"	
3" x 1½"	7.985"	
3" x 2"	6.010"	
3" x 2½"	4.068"	
4" x 1½"	12.115"	
4" x 2"	10.140"	
4" x 2½"	8.198"	
4" x 3"	6.250"	

Call for availability.
6" - 8" see Larger Materials Brochure.

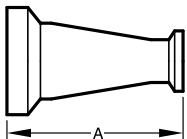
concentric reducer female by female		B31I-15I-15I
od tube size	A	
1½" x 1"	3.735"	
2" x 1"	5.825"	
2" x 1½"	3.990"	
2½" x 1½"	6.110"	
2½" x 2"	4.200"	
3" x 1½"	8.170"	
3" x 2"	6.260"	
3" x 2½"	4.380"	
4" x 1½"	12.300"	
4" x 2"	10.390"	
4" x 2½"	8.510"	
4" x 3"	6.570"	

Call for availability.
6" - 8" see Larger Materials Brochure.



International Association of
Food Industry Suppliers

eccentric

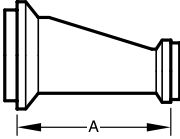
eccentric reducer male by male		B32I-14I
od tube size	A	
1½" x 1"	3.365"	
2" x 1"	5.390"	
2" x 1½"	3.555"	
2½" x 1½"	5.613"	
2½" x 2"	3.638"	
3" x 1½"	7.665"	
3" x 2"	5.690"	
3" x 2½"	3.748"	
4" x 1½"	11.803"	
4" x 2"	9.828"	
4" x 2½"	7.886"	
4" x 3"	5.938"	

Call for availability.
6" - 8" see Larger Materials Brochure.

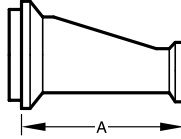
eccentric reducer male by female		B32I-14I-15I
od tube size	A	
1½" x 1"	3.550"	
2" x 1"	5.575"	
2" x 1½"	3.740"	
2½" x 1½"	5.798"	
2½" x 2"	3.888"	
3" x 1½"	7.858"	
3" x 2"	5.948"	
3" x 2½"	6.068"	
4" x 1½"	11.988"	
4" x 2"	10.078"	
4" x 2½"	8.198"	
4" x 3"	6.258"	

Call for availability.
6" - 8" see Larger Materials Brochure.

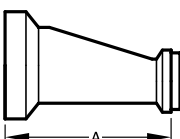
eccentric reducer female by male		B32I-15I-14I
od tube size	A	
1½" x 1"	3.550"	
2" x 1"	5.640"	
2" x 1½"	3.805"	
2½" x 1½"	5.925"	
2½" x 2"	3.950"	
3" x 1½"	7.985"	
3" x 2"	6.010"	
3" x 2½"	4.068"	
4" x 1½"	12.115"	
4" x 2"	10.140"	
4" x 2½"	8.198"	
4" x 3"	6.250"	

Call for availability.
6" - 8" see Larger Materials Brochure.

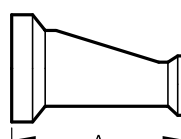
eccentric reducer female by female		B32I-15I-15I
od tube size	A	
1½" x 1"	3.735"	
2" x 1"	5.825"	
2" x 1½"	3.990"	
2½" x 1½"	6.110"	
2½" x 2"	4.200"	
3" x 1½"	8.170"	
3" x 2"	6.260"	
3" x 2½"	4.380"	
4" x 1½"	12.300"	
4" x 2"	10.390"	
4" x 2½"	8.510"	
4" x 3"	6.570"	

Call for availability.
6" - 8" see Larger Materials Brochure.

gaskets

type	A3 qualified	meets 21CFR 177.2600	pharmaceutical class VI approved	useful temperature range
Buna-N (black or white)	✓	✓		-40° - 225°F
Teflon® (PTPE)	✓	✓	✓	-110° - 400°F
Viton (flourel)	✓	✓	✓	-20° - 450°F
EPDM	✓	✓	✓	-55° - 275°F

call for more information for your specific needs

gasket style

1" - 8"

800.789.1718

get connected with

Bradford Company, Inc.



clamps

end caps

hangers

ferrules

elbows

tees

laterals

reducers

valves

gaskets



Bradford Company, Inc.

PO Box 33 • Elm Grove, WI 53122-0033

262.790.0101 • 800.789.1718

fax 262.790.1046

www.bradfordfittings.com

